



Zephyr Lock

BETTER SECURITY THROUGH INNOVATION

Model 5200 Club Series Electronic RFID Locker Lock System

Metal Locker Installation Instructions

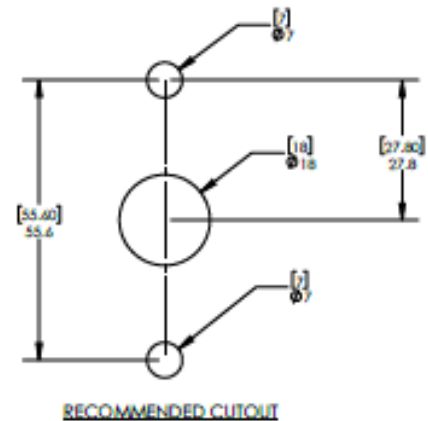
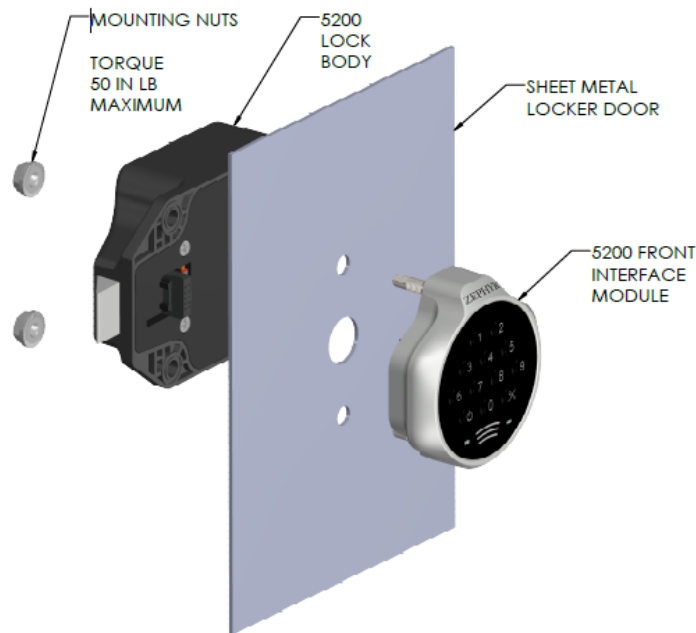

Instructions:

1. DO NOT pull ribbon connector out of lock body. Pin connector should be seated in the tabs on the back plate.
2. Align the locking body on the rear of the locker door. The pin connector should protrude through the center hole.
3. Connect the front keypad to the front of the locker door by aligning the threaded stem connectors with the upper and lower holes.
4. Press the locking body and keypad together slowly until the pin connector properly seats.
5. Attached the two included nuts to the threaded stems and finger tighten.
6. To test for proper connection, remove the plastic battery tab from the rear of the locking body.
7. Press the power button. If connected properly the lock will beep once and the green light will flash 10 times.
8. Tighten nuts with 3/8" nut driver, Do Not Exceed 50lbs of torque.

