



# Zephyr Lock

BETTER SECURITY THROUGH INNOVATION

## Model 2100 & 2200 Traditional Series Electronic RFID Locker Lock System

### Metal Locker Installation Instructions

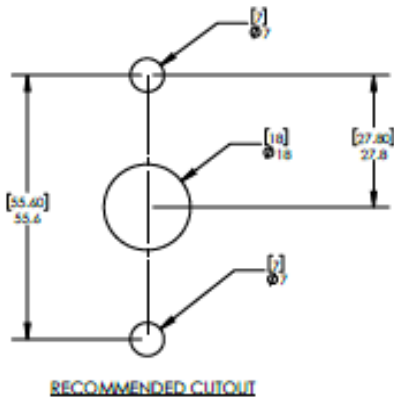

1. Locate the 3-hole mounting pattern on the locker door. If blocking plate is attached, remove to expose mounting holes.
2. **DO NOT pull ribbon connector out of lock body.** Pin connector should be standing on base at 90 degrees from the back of the rear body.
3. Align the locking body on the rear of the locker door. The pin connector should protrude through the center hole. **DO NOT pull ribbon connector out of lock body.**
4. Connect the front keypad to the front of the locker door by aligning the threaded stem connectors with the upper and lower holes.
5. Press the locking body and keypad together slowly until the pin connector properly seats.
6. Attached the two included nuts to the threaded stems and finger tighten. Make sure lock is aligned properly and not rubbing
7. If mounted properly the lock will beep once, pause, and then play a 4-tone melody. To test for proper mounting test by locking and locking with code while door is open. Test sequence is Zephyr button - 1 - 2 - 3 - 4 - Zephyr button.
8. Close door and test the lock again. Make sure there is no binding between the bolt and the lockers strike plate and or frame. Adjust the lock if necessary. Press the power button.
9. Tighten nuts with 3/8" nut driver or wrench. **Do Not Exceed 50lbs of torque.**

